

DV2120

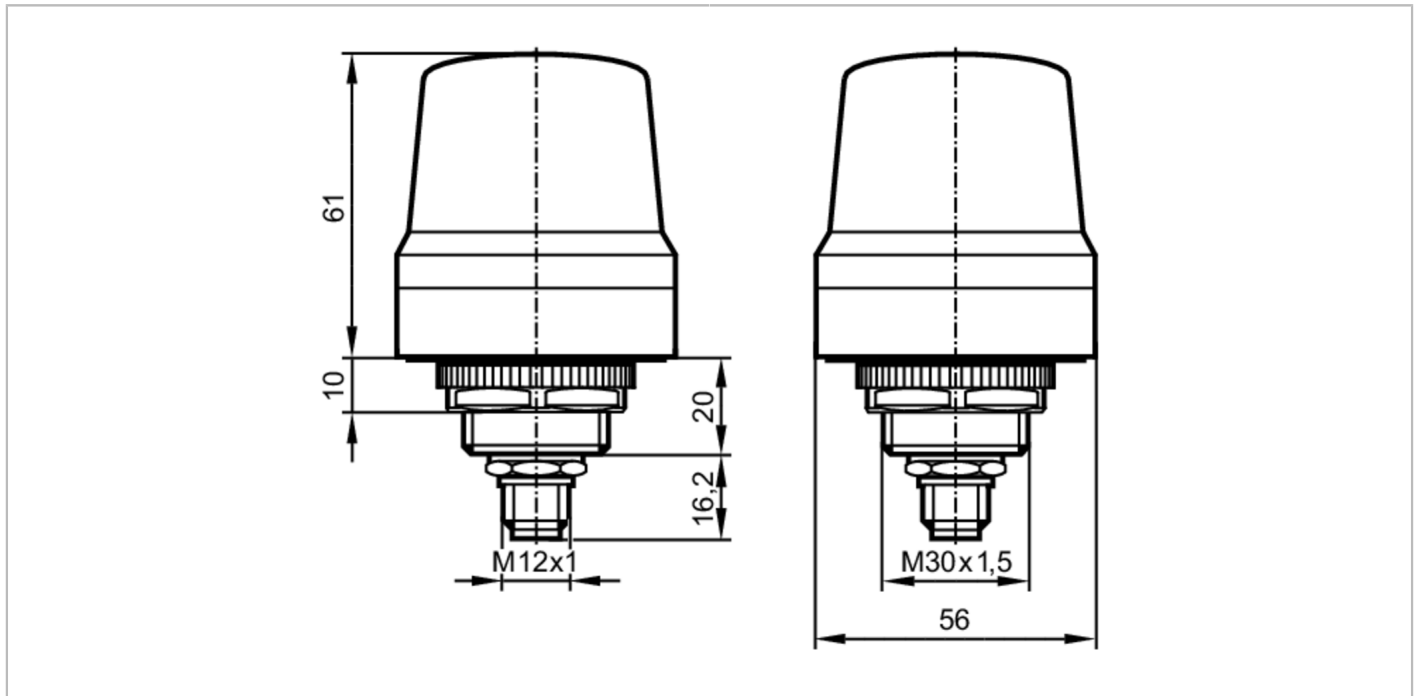

1-segment signal lamp

LED-Lamp/IO-Link



| Application | |
|--------------------------------------|--------------------------------------------------------|
| Application | signaling machine conditions |
| Electrical data | |
| Operating voltage [V] | 18...30 DC; (to SELV/PELV ; "supply class 2" to cURus) |
| Nominal voltage DC [V] | 24 |
| Current consumption [mA] | < 90 |
| Switch-on peak current [mA] | 400 |
| Switch-on peak current duration [ms] | 50 |
| Interfaces | |
| Communication interface | IO-Link |
| Transmission type | COM2 (38,4 kBaud) |
| IO-Link revision | 1.1 |
| SDCI standard | IEC 61131-9 |
| SIO mode | yes |
| Required master port class | A |
| Min. process cycle time [ms] | 2.3 |
| Supported DeviceIDs | Type of operation |
| | default |
| | DeviceID |
| | 1054 |
| Operating conditions | |
| Ambient temperature [°C] | -25...50 |
| Storage temperature [°C] | -40...75 |
| Max. relative air humidity [%] | 90 |
| Max. height above sea level [m] | 4000 |
| Protection | IP 67 |

DV2120



1-segment signal lamp

LED-Lamp/IO-Link

| | |
|-------------------|---|
| Degree of soiling | 2 |
|-------------------|---|

Mechanical data

| | |
|-----------------|---------------|
| Weight [g] | 153 |
| Dimensions [mm] | Ø 56 / L = 61 |
| Material | housing: PC |

Displays / operating elements

| | |
|---------|-----------------------------------------------------------------|
| Display | LED segment, red / green / yellow / blue / lilac / cyan / white |
|---------|-----------------------------------------------------------------|

Accessories

| | |
|------------------------|------------------------------------------|
| Accessories (optional) | mounting base, E89060 |
| | wall bracket, E89061 |
| | Mounting adapter, E89063 |
| | bracket with lateral cable entry, E89064 |
| | mounting tube, E89065 |
| | mounting tube, E89066 |
| | mounting tube, E89067 |
| | mounting base, E89080 |

Remarks

| | |
|---------------|-------------------------------------------------|
| Remarks | Further information is available in the manual. |
| Pack quantity | 1 pcs. |

Electrical connection - plug

Connector: M12; coding: A

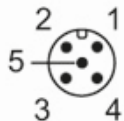

IO-Link

| | |
|---|----------|
| 1 | UB+ |
| 2 | not used |
| 3 | UB- |
| 4 | IO-Link |
| 5 | not used |

standard mode

| | |
|---|-----------|
| 1 | IN1 red |
| 2 | IN2 green |
| 3 | GND |
| 4 | not used |
| 5 | IN3 blue |

DV2120



1-segment signal lamp

LED-Lamp/IO-Link

Diagrams and graphs

base mounting

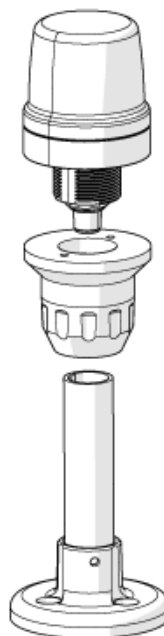

wall mounting

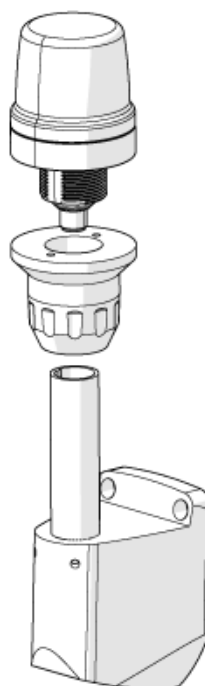

DV2120



1-segment signal lamp

LED-Lamp/IO-Link

light intensity distribution curve

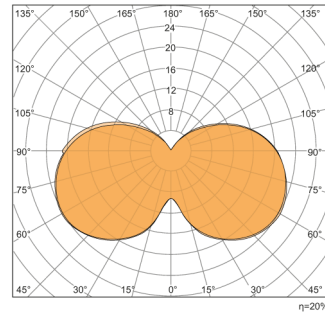

light intensity distribution curve: red

1000 lm

operating efficiency = 20%

light intensity distribution curve

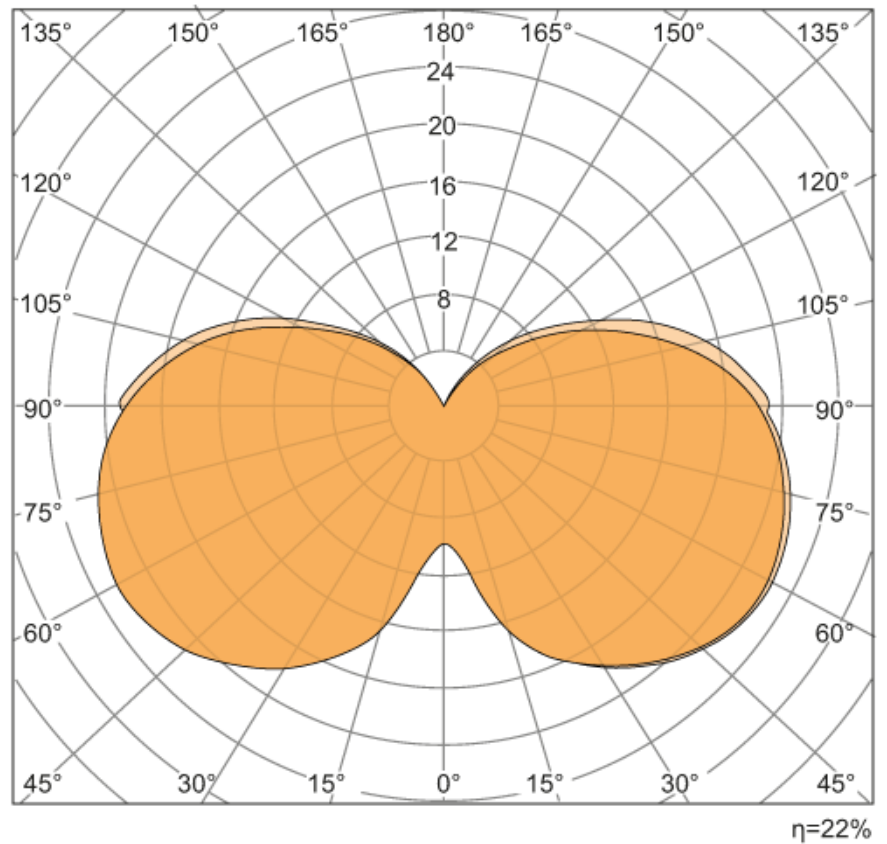

light intensity distribution curve: green

1000 lm

operating efficiency = 22%

DV2120



1-segment signal lamp

LED-Lamp/IO-Link

light intensity distribution curve

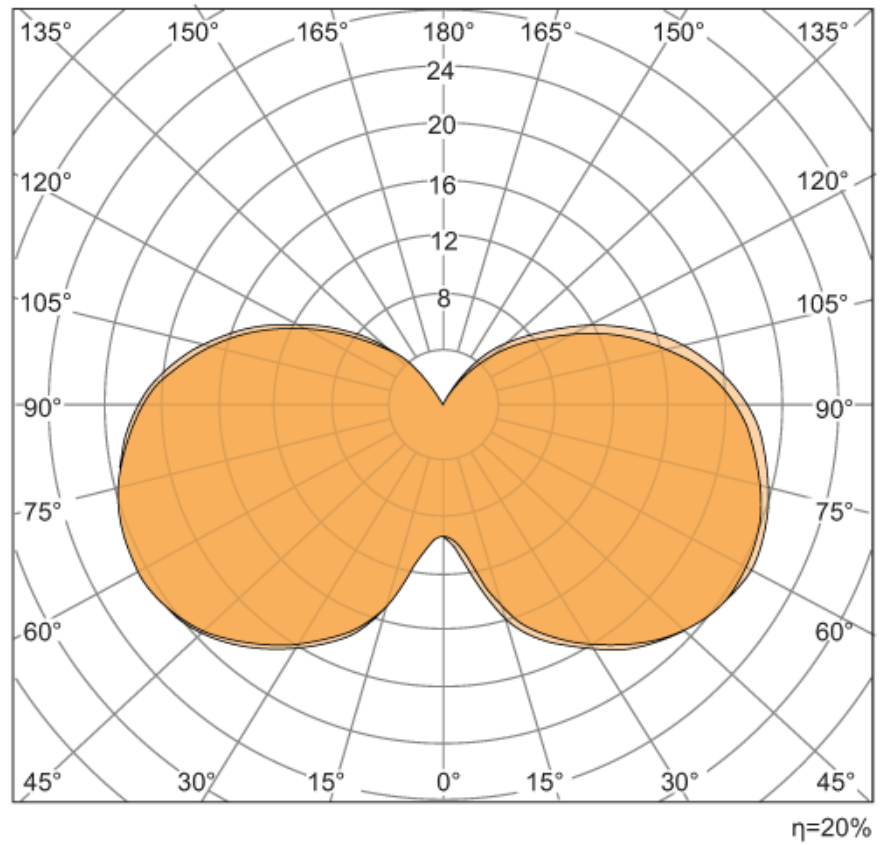

light intensity distribution curve: blue

1000 lm

operating efficiency = 20%