

1	2	3	4	5	6
RevNo	Revision note			Date	Signature Checked

AT5 Pulley with 60 Teeth
Designed for use with
10mm wide belts

A

B

C

A

B

C

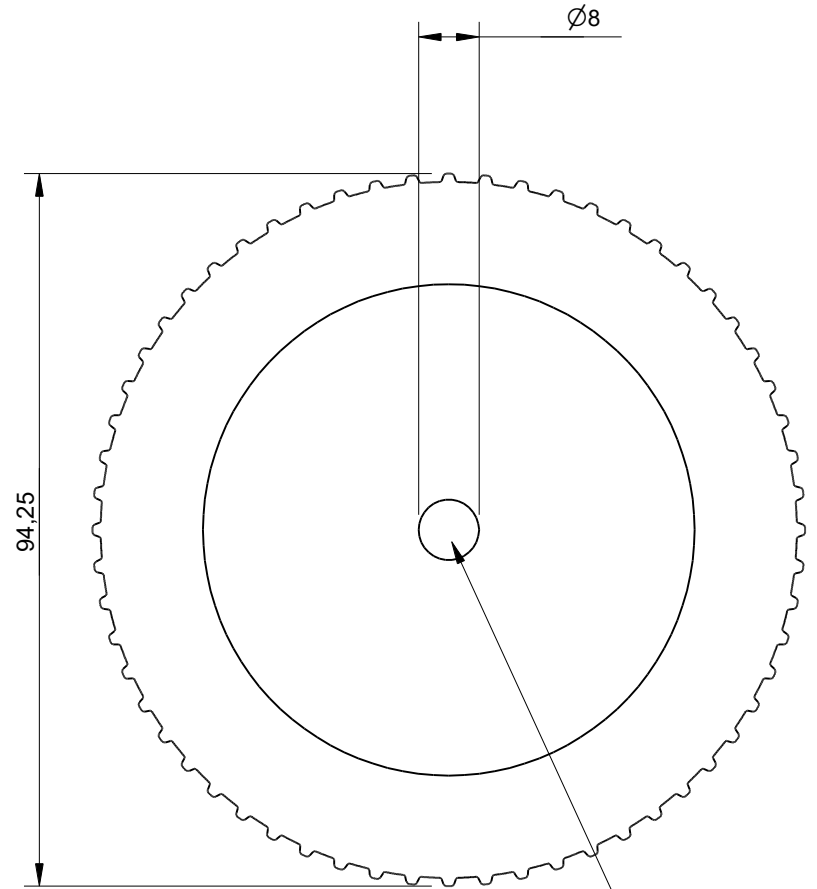
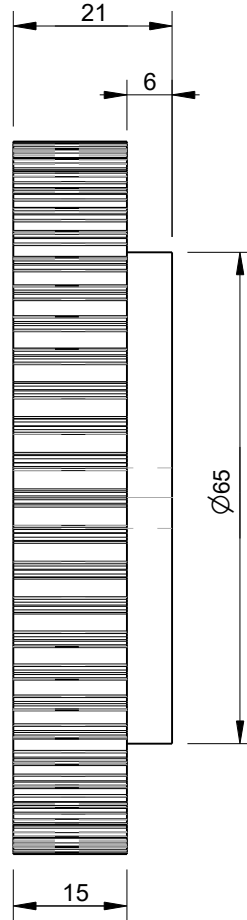
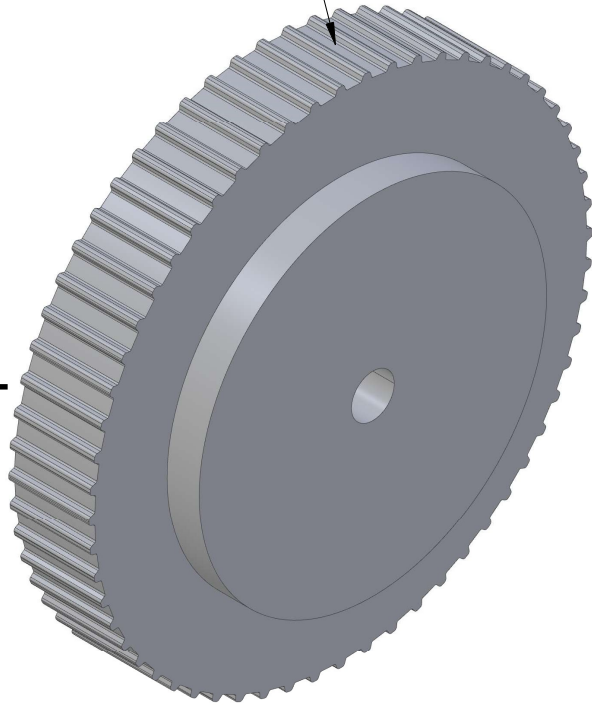

This AT5 pulley size has a bore of 8mm

Effective (Outer) Diameter	94.25mm
Pitch Diameter	95.45mm
Weight	0.31kg
With Flanges?	no
Material	Aluminium
Units	mm
Tolerances	+/-0.1mm

D

D

Itemref	Quantity	Title/Name, designation, material, dimension etc			Article No./Reference	
Drawn by Kevin Damen	Checked by	Approved by - date	File name	Date 20-1-2024	Scale 1:1	

6580

www.damencnc.com

6580 AT5 Pulley 21-AT5 Z=60
for 10mm wide belts

Edition	Sheet 1 OF 1
---------	-----------------

1

2

3

4

5

6