

1	2	3	4	5	6
RevNo	Revision note			Date	Signature
					Checked

Suitable for $\varnothing 32$ mm ballscrews

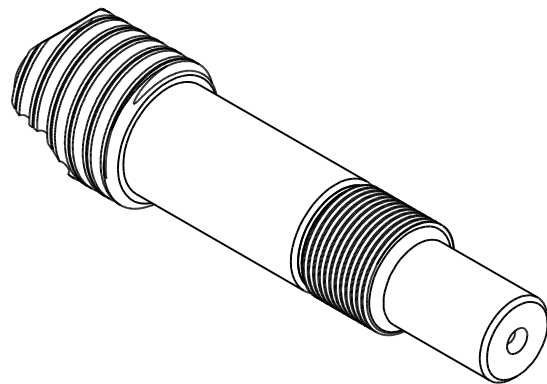
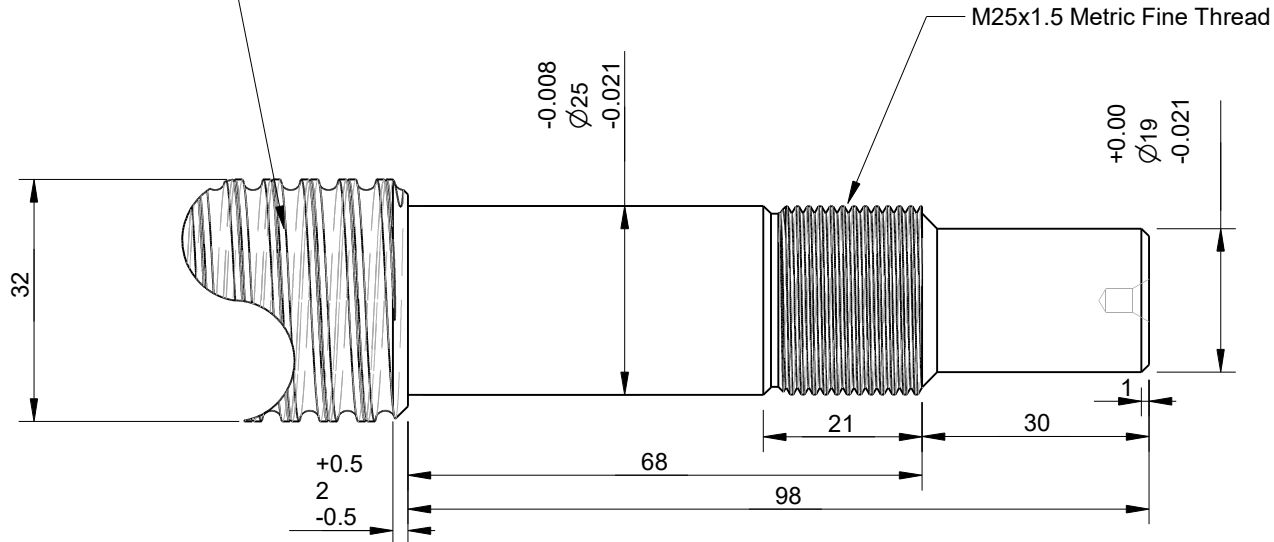

WARNING: When used with FK25 bearingblock, a shorter spacer is required, (9mm instead of 14mm) our part number 5349 (We include it with the delivery when you order FK25 from DamenCNC)

Itemref	Quantity	Title/Name, designation, material, dimension etc			Article No./Reference	
Drawn by Kevin Damen	Checked by Rutger Schuit	Approved by - date 11-2-2022	File name	Date 31-10-2020	Scale 1:1	

8125

www.damencnc.com

8125 BK / FK 25 Ballscrew End Machining Fixed side	Edition	Sheet 1 OF 1
---	---------	-----------------

Units: mm
Tolerances: +/- 0.1mm unless otherwise specified
WARNING: Ballscrew not included in the delivery